

# REED HALL

Reed Hall is a grand Italianate Mansion built in 1867. It is a fine example of traditional architecture complemented by modernity. With all year round availability, Reed Hall is a self-contained centre, set amongst grounds regularly described as 'one of the most beautiful campuses in England'.

## VENUES

with  
event exeter

# REED HALL GROUND FLOOR

## FACILITIES



FACILITIES AT A GLANCE					
	Theatre	Boardroom	Classroom	Cabaret	Dining
Upper Lounge	80	34	18	43	50
Ibrahim Ahmed Room	40	19	15	25	19
Margaret Hewitt Room	19	11	8	15	11
Garden Room	21	13	8	10	13
Walter Daw Room	19	11	8	15	11
Thornton West Room	-	16	-	-	-
Woodbridge Dining Room	100	-	-	-	-
Bar Lounge	-	-	-	-	-

Room capacities can be greater if Audio Visual equipment is not being used.



# REED HALL GROUND FLOOR

## ROOM SIZES AND DESCRIPTIONS

**VENUES**  
with event exeter

IBRAHIM AHMED ROOM	
Length	8.18m to window alcove
Width	5.09m
Height (floor to ceiling)	3.87m
Heating	Radiator
Lighting	Natural 1 central light fitting
Ventilation	Windows
Access Doors	Width 0.84m Height 1.22m
Flooring	Carpet
Accessible Seating	All chairs are moveable due to the flat floor in this area. Wheelchair seating can therefore be arranged in line with the organiser's requirements.
Power Supplies	3

GARDEN ROOM	
Length	7.20m
Width	4.49m
Height (floor to ceiling)	3.90m
Heating	Radiator
Lighting	Natural 1 central light fitting
Ventilation	Windows
Access Doors	Width 0.84m Height 1.13m
Flooring	Carpet
Accessible Seating	All chairs are moveable due to the flat floor in this area. Wheelchair seating can therefore be arranged in line with the organiser's requirements.
Power Supplies	3

MARGARET HEWITT ROOM	
Length	6.28m
Width	4.34m
Height (floor to ceiling)	3.87m
Heating	Radiator
Lighting	Natural, 1 central light fitting
Ventilation	Windows
Flooring	Carpet
Access Doors	Width 0.84m Height 1.22m
Accessible Seating	All chairs are moveable due to the flat floor in this area. Wheelchair seating can therefore be arranged in line with the organiser's requirements.

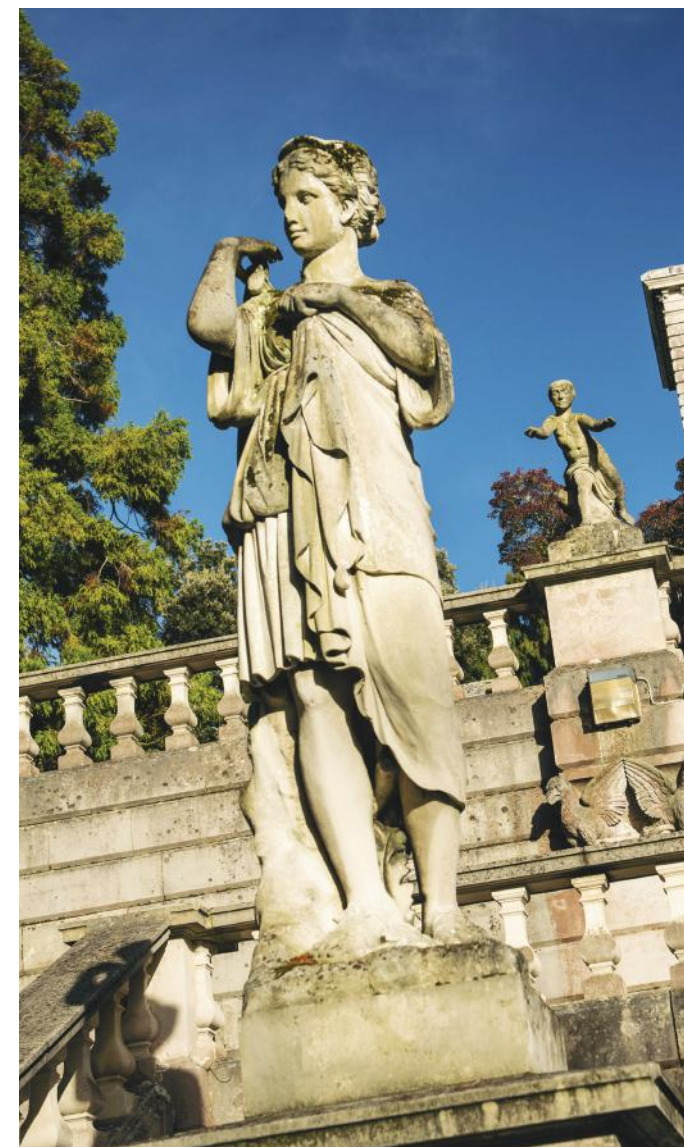

# REED HALL GROUND FLOOR

## FLOOR PLAN

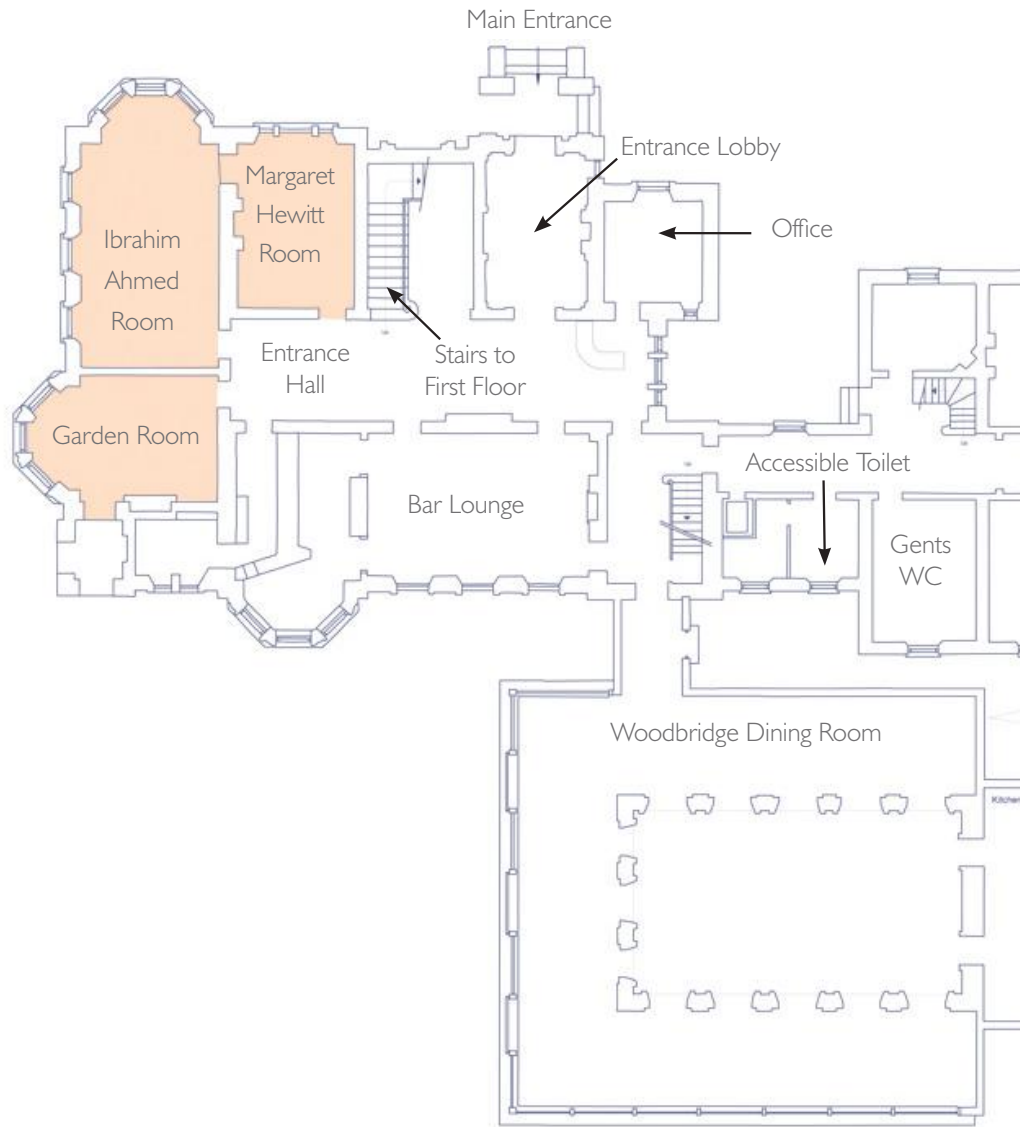

**VENUES**  
with event exeter



# REED HALL FIRST FLOOR

## ROOM SIZES AND DESCRIPTIONS

**VENUES**  
with event exeter

THORNTON WEST ROOM	
Length	5.49m
Width	4.43m
Height (floor to ceiling)	3.76m
Heating	Radiator
Lighting	Natural 1 central light fitting
Ventilation	Windows
Access Doors	Width 0.84m Height 1.22m
Flooring	Carpet
Accessible Seating	No access to first floor
Power Supplies	5

WALTER DAW ROOM	
Length	6.40m
Width	4.64m
Height (floor to ceiling)	3.76m
Heating	Radiator
Lighting	Natural 1 central light fitting
Ventilation	Windows
Access Doors	Width 0.84m Height 1.22m
Flooring	Carpet
Accessible Seating	No access to first floor
Power Supplies	3

UPPER LOUNGE	
Length	15.18m
Width	5.49m
Height (floor to ceiling)	3.76m
Heating	Radiator
Lighting	Natural, 1 central light fitting
Ventilation	Windows
Flooring	Carpet
Access Doors	Width 0.84m Height 1.22m
Accessible Seating	No access to first floor
Power Supplies	11



# REED HALL FIRST FLOOR

FLOOR PLAN

